

Typical roof

Asphalt Shingles
 3/8" OSB Roof Sheathing Pre-manufactured
 Engineered Roof Trusses @ 24" o.c.
 2 x 4 @ 16" o.c.

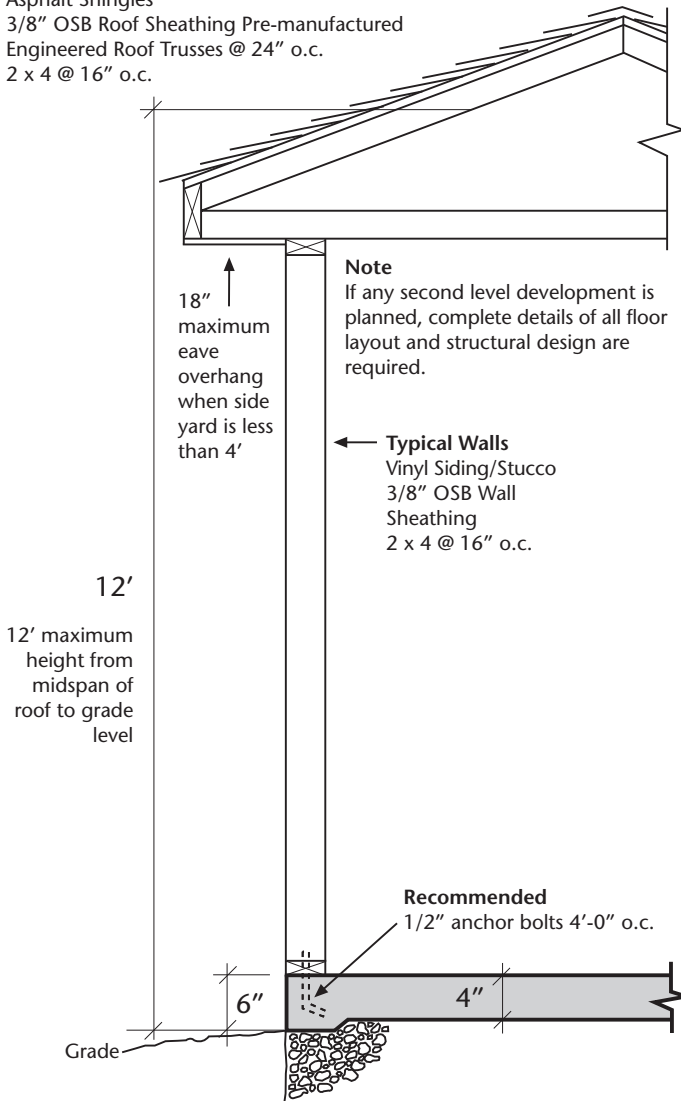

Note
 If any second level development is planned, complete details of all floor layout and structural design are required.

Typical Walls
 Vinyl Siding/Stucco
 3/8" OSB Wall Sheathing
 2 x 4 @ 16" o.c.

Recommended
 1/2" anchor bolts 4'-0" o.c.

Additional Notes

- ◆ Windows cannot be placed in a wall that is less than 4' to the property line.
- ◆ If the roof framing members transfer roof loading to the overhead garage door beam, specify the size of the beam.
 - Door opening width up to 9'-5" requires a minimum 2 ply - 2" x 10".
 - Door opening up to 16'-6" requires a minimum 4 ply - 2" x 12" or engineered beams may be substituted if supplier letter and details are submitted.
- ◆ Garages up to 590 sq. ft. (No dimension over 30') can have a minimum 4" concrete slab or the walls can be supported on a treated mud-sill.
- ◆ Maximum size of detached garage on a slab thickening foundation is 728 sq. ft. with no dimension exceeding 30'.
- ◆ Oversized garages will require engineer design or a generic grade beam pile design can be submitted.
- ◆ A garage cannot be built over an underground gas line unless you have prior approval from ATCO Gas.
- ◆ All garages must have a man door.

Alternate Concrete Curb Detail

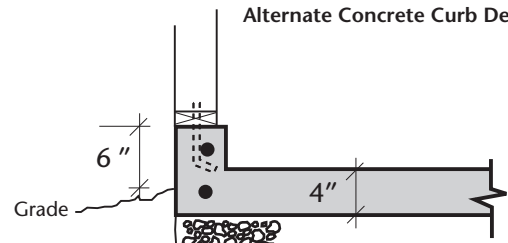

Note
 6" clearance required from bottom of untreated wood to grade or submit equivalent base protection details.

Alternate Foundation (590-728 sq. ft.)

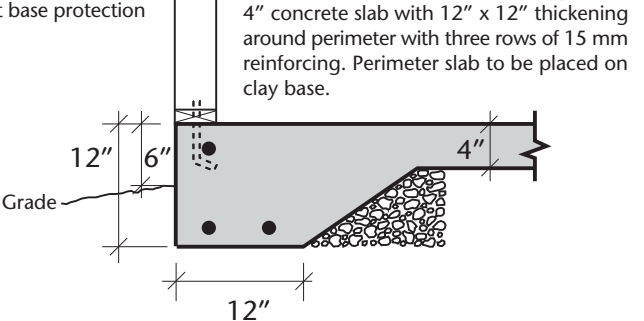

Please check off garage construction details as listed below:

Roof

- Roofing Material
- Asphalt Shingles
 - Cedar, Pine Shakes/Shingles
 - Metal Roofing
 - Other _____

Roof Sheathing

- 3/8" OSB
- 3/8" plywood
- 1/2" plywood
- 1/2" OSB
- Other _____

Roof Framing

- Pre-manufactured Engineered Truss
- Stick Built Roof Framing
- 2 x 4 @ 16 or 24" o.c.
- 2 x 6 @ 16 or 24" o.c.
- Other _____

Walls

- Exterior Finish
- Vinyl Siding
 - Stucco
 - Painted Plywood
 - Metal Siding
 - Other _____

Wall Sheathing

- 3/8" OSB
- 3/8" plywood
- 1/2" plywood
- 1/2" OSB
- Other _____

Wall Framing

- 2 x 4 @ 16" o.c.
- 2 x 4 @ 24" o.c.
- 2 x 6 @ 16"/24" o.c.
- Insulated walls and ceiling
- Interior finish (drywall, etc.)

Please complete

_____ Date _____

_____ Applicant Name (please print) _____

_____ Signature _____

_____ Address _____, Edmonton